

# WD-90GR FLEX

## POT DISHWASHER (with or without granules)

- Efficient frontloaded potwasher, washes pots and pans with or without granules.
- Excellent washing results and fast drying with efficient and energy saving centrifuging spin cycle.
- Perfect for space efficient installations
- No manual pre-wash or scrubbing thanks to heavy rinsing with water and granules
- Stacking of goods can be made directly on the hinged door.
- Square washing cassette for containers, holds eight 1/2 or four 1/1 containers.
- Wide range of accessories for various items.
- Accessories for washing 65 and 40 mm-deep 2/1 containers and baking trays 600x400 mm.
- Hinged door enables for easy cleaning.
- Six different wash programs with HACCP function.
- Service can easily be made from the front or side
- Accessories incl in delivery: 1 pc square cassette, 3 pcs support wall, 3 pcs side holder, 1 pc flexibel insert, cleaning scraper and granules 10 kg.



### OPTIONS

- Marine version 400V/3/50 without neutral
- Marine version 440V/3/60 without neutral
- Steam heated design, pressure 50-250 kPa
- Booster pump
- Break tank incl. booster pump
- Stainless couplings in the final rinse
- Connection power restriction
- Connection power restriction SicoTronic
- External power indication
- Web Tool with HACCP documentation and cost- and consumption report
- Drain pump

### EXTRA EQUIPMENT

- Table trolley
- Sorting bench
- Holder for accessories, to be placed on the side of the machine
- Square cassette 209.7296 (1 pc included in the delivery)
- Cassette for canteens with handles
- Cassette for large boxes
- Basket for 4 pc GN 1/1-canteens - 200 mm deep
- Granules 10 kg (included in the delivery)
- Cleaning scraper (1 pc included in the delivery)

### ACCESSORIES FOR CASSETTES

- All-round holder 209.7273
- Holder for utensils 209.7277
- Wire basket for small utensils 209.7278
- Holder for small pots 209.7279
- Support wall 209.7280 (1 pc included in the delivery)
- Flexible insert, to be used together with 209.7354 209.7281
- Holder for 1/3, 1/6 and 1/9 containers. 209.7282
- Holder for 1/4, 1/6 containers 209.7286
- Side holder 209.7354
- Rubber strap 209.7272

TECHNICAL DATA	WD-90GR FLEX
Granule pump (kW)	2,2
Wash pump (kW)	1,5
Motor for the round table (kW)	0,18
Booster heater (kW)	9
Heater tank (kW)	9
Tank volume (litres)	100
Weight, machine in operation (kg)	430
Granule volume (litres)	5
Degree of protection (IP)	IP55

CAPACITY AND OPERATION DATA	WD-90GR FLEX
Total time/wash program 1** (min) washing with granules, with spin (can be excluded by technician)	5
Total time/wash program 2** (min) washing with granules, with spin (can be excluded by technician)	8
Total time/wash program 3** (min) washing with granules, with spin (can be excluded by technician)	10,3
Total time/wash program 4** (min) washing without granules, with spin (can be excluded by technician)	2,3
Total time/wash program 5** (min) washing without granules, with spin (can be excluded by technician)	3,8
Total time/wash program 6** (min) washing without granules, with spin (can be excluded by technician)	6,8
Capacity, max (1/1 containers/program)****	4
Capacity, max (1/2 containers/program)****	8
Capacity / h, Pr 1 (1/1-containers) incl. handling ****(pc)	45
Capacity / h, Pr 1 (1/2-containers) incl. handling ****(pc)	90
Water consumption rinse/program (litres) *****	3,5-5

CAPACITY AND OPERATION DATA	WD-90GR FLEX
Water consumption cooling/program (litres) *****	0-1,5
Energy consumption (kWh of connected power)	70-90%
Steam consumption *** (kg/h)	15
Sound level* (dB(A)) washing program with granules	69
Max. surface temp. at room temp. 20°C (°C)	30

\* A-weighted sound pressure level, LpA

\*\* Factory setting. The wash time is adjustable

\*\*\* Steam heated machine

\*\*\*\* Max. capacity depending on the depth of the containers.

\*\*\*\*\* Applies under ideal conditions and program using spinning.

The water consumption depends on local conditions. An exact adjustment is made during installation.

CONNECTION, ELECTRICALLY HEATED MACHINE	WD-90GR FLEX
Total connected power (kW)	11,3
Main fuse 400V 3N~ (A)*	20
Max.conn.area 400V 3N~ (L1-L3,N,PE) Cu (mm²)	6

\* Other voltages on request

CONNECTION, STEAM HEATED MACHINE 50-250 KPA	WD-90GR FLEX
Total conn.power (kW)	2,4
Main fuse 400V 3N~(A)*	16
Max.conn.area 400V 3N~(L1-L3, N, PE) Cu (mm²)	6
Steam connection (internal thread)	R½"
Connection condense water (internal thread)	R½"

\* Other voltages on request

CONNECTION WATER, DRAIN AND VENTILATION	WD-90GR FLEX
Water quality, hardness (°dH)	2 - 7
Cold water connection 5-12°C (internal thread)	R½"
Hot water connection 50-65°C (internal thread)	R½"
Drain connection, PP pipe (ø mm)	50
Water capacity warm water, pressure (kPa)	250
Water capacity warm water, flow (litres/min)	15
Water capacity cold water cooling, min/max pressure (kPa)	100/160
Floor drain, capacity (litres/sec)	3
Ventilation of the machine (m³/h)	600

SIZE AND WEIGHT FOR TRANSPORTATION	WD-90GR FLEX
Size * LxWxH (mm)	1060x900x1950
Weight * (kg)	340

\* Packaging included

# ACCESSORIES FOR WD-90GR FLEX



*Square shaped cassette, part. no. 209.7276  
Included in the delivery.*



*Side holder, part. no. 209.7354  
3 pcs included in the delivery.*

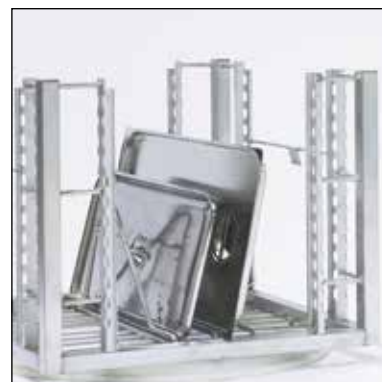

*Lid holder, part. no. 209.7280  
3 pcs included in the delivery.*



*Flexible insert, part. no. 209.7281  
Used together with side holder.  
Included in the delivery.*



*Utensil holder, part. no. 209.7277*



*Wire basket, part. no. 209.7278*

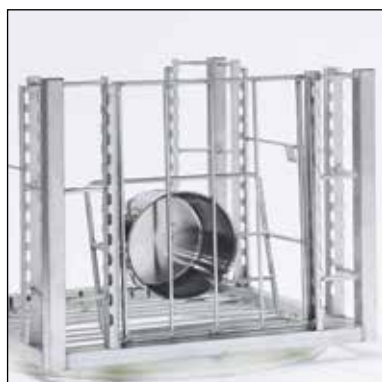

*Holder, part. no. 209.7279  
For small pots and bowls.*



*Allround holder, part. no. 209.7273  
For pots with handles and ABC-  
containers.*



*Holder for 1/3, 1/6, 1/9 containers,  
part. no. 209.7282*

The above accessories are a selection of Wexiödisk's range. Additional equipment for other kind of dishes can be requested.

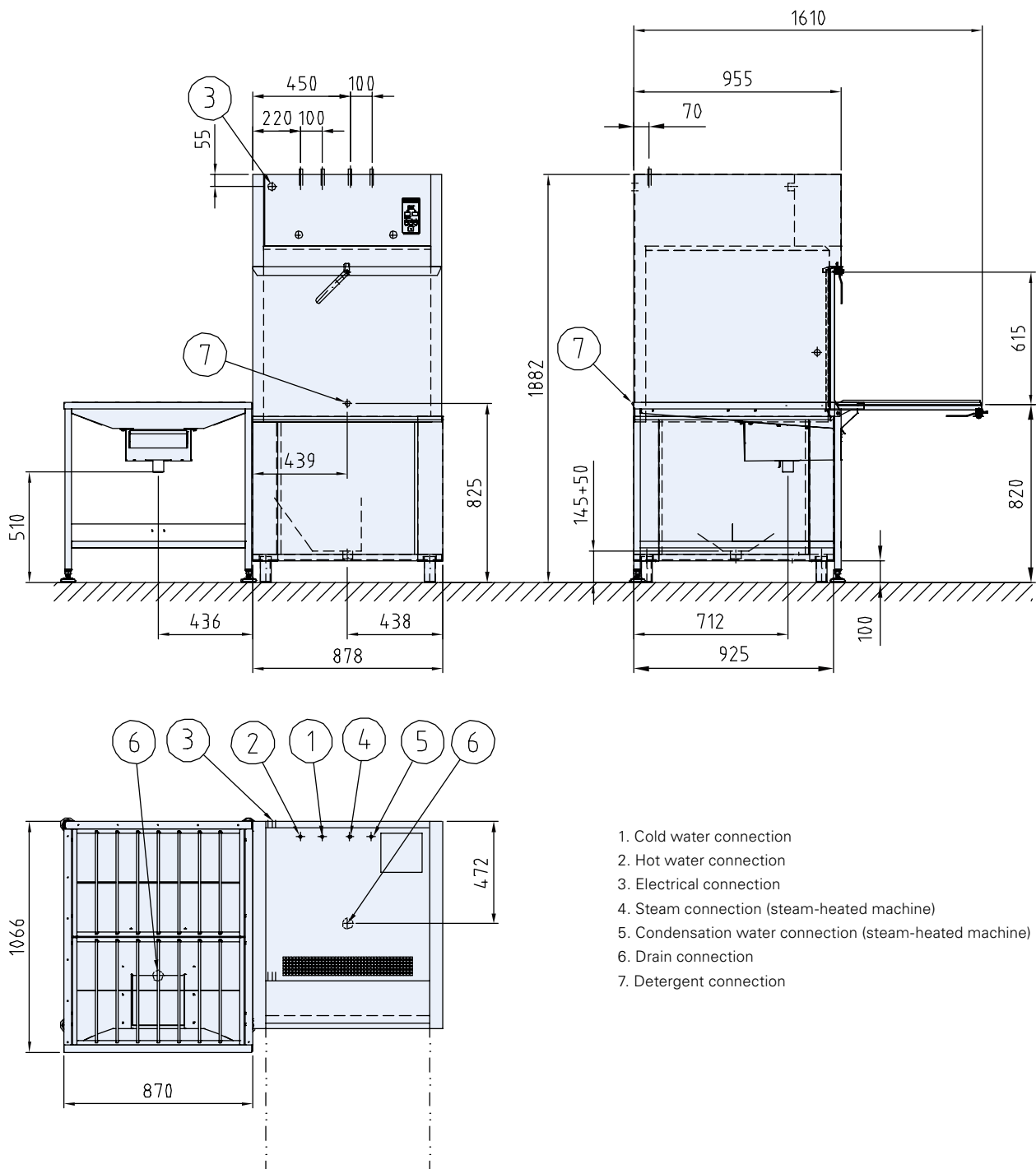

We reserve the right to change technical data.

# Wexiödisk

TELEPHONE: +46 470 77 1200 FAX: +46 470 23752 ADDRESS: Mårdvägen 4 SE-352 45 Växjö SWEDEN  
E-MAIL: wexiodisk@wexiodisk.com WEBB: www.wexiodisk.com